



HYB-LTT-01-05

Written By: Hybrid Racing



Step 1 — J-Series, C-Series & F20C/F22C



- Make sure you are using the appropriate gasket for your engine application. This gasket should come preinstalled on the thermostat.
- This gasket fits most J-Series, F20C/F22C, C-Series engines.
- The gasket is symmetrical.

Step 2 — H22 gasket



- The extra gasket in the package is ONLY for the Honda H22 engines.
- It is not symmetrical.
- Make sure you install the gasket correctly with the nipples on the same side as the spring.

Step 3 — C30/C32 NSX

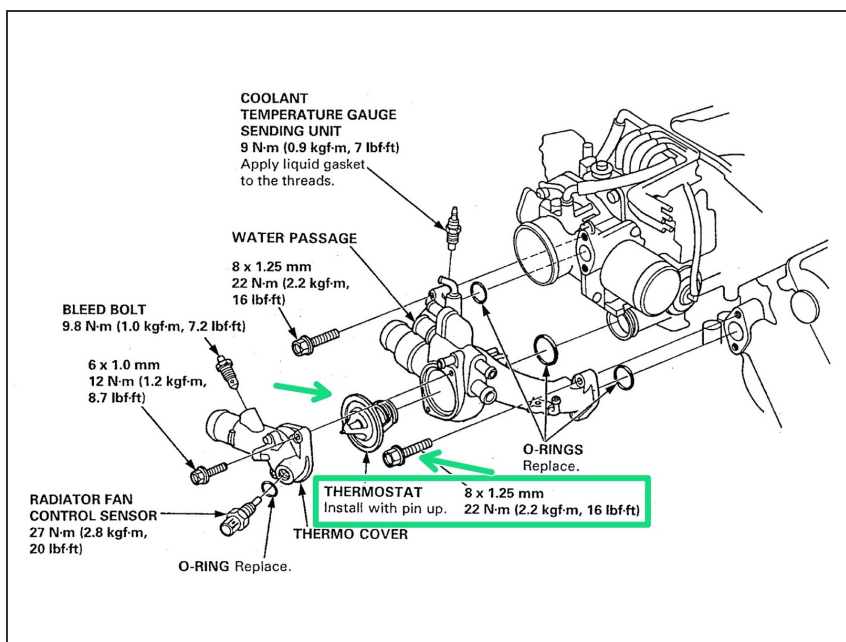

- Install with the pin up. Do not install upside down.
- Torque bolts to 8.7lbft.

Step 4 — F20C/F22C S2000

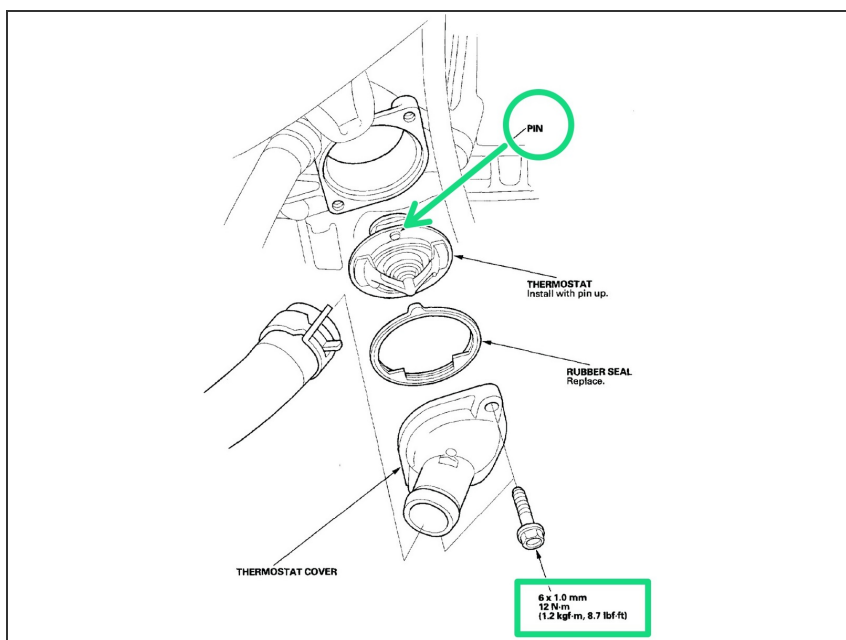

- Install with the pin up. Do not install upside down.
- Torque bolts to 8.7lbft.

Step 5 — J35 Accord / J32 CL

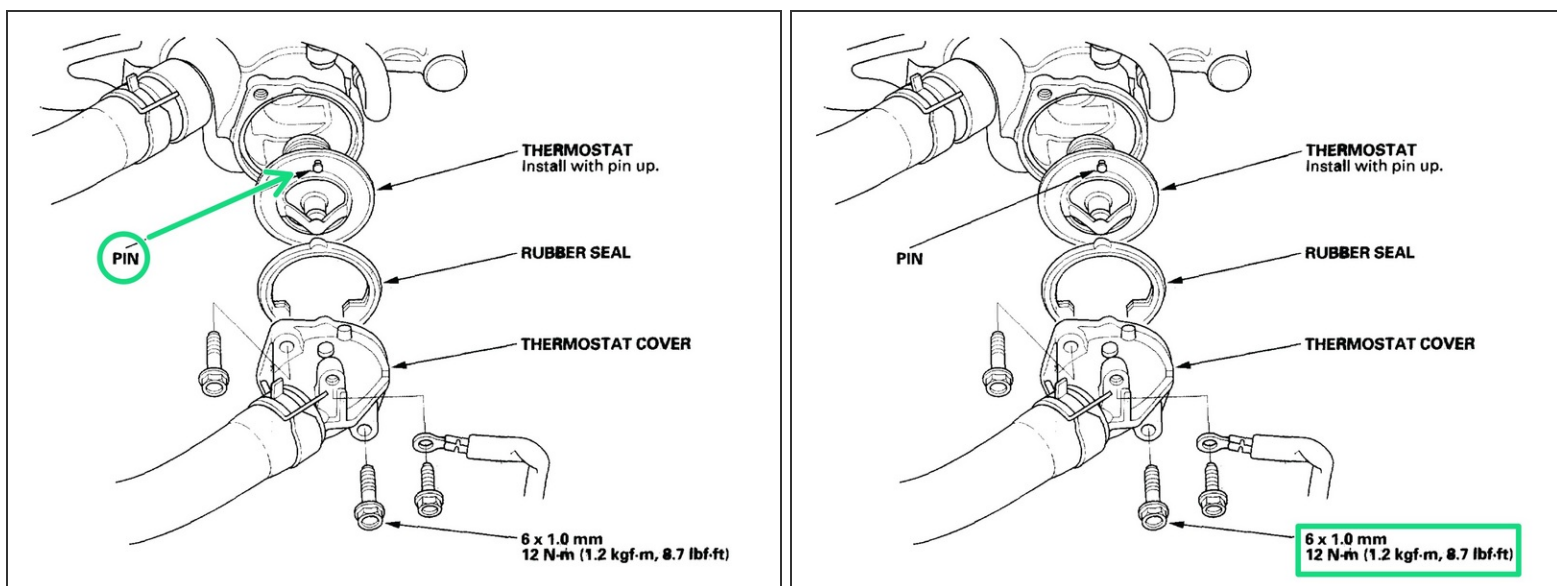

- Install with the pin up. Do not install upside down.
- Torque bolts to 8.7lbft.

Step 6 — J30 Accord

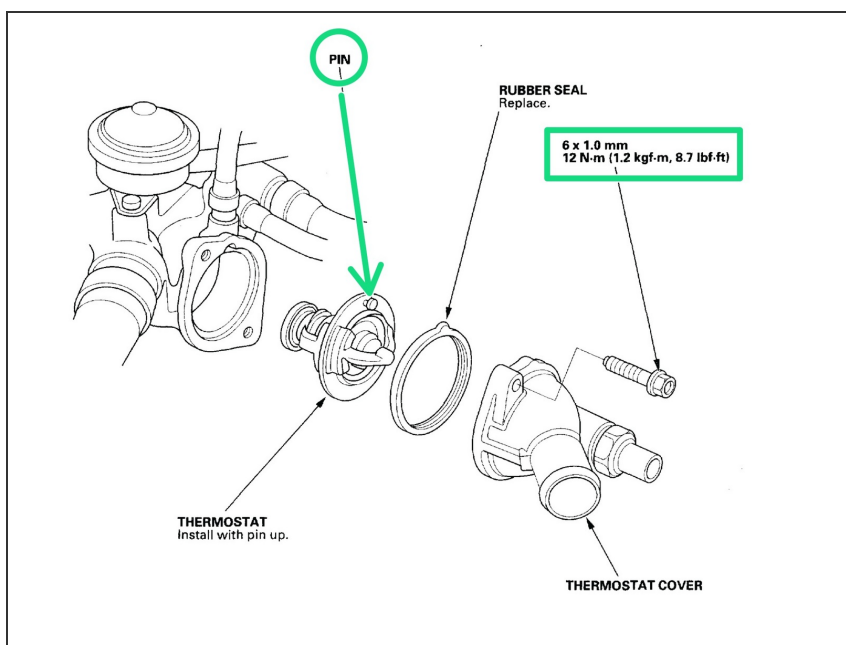

- Install with the pin up. Do not install upside down.
- Torque bolts to 8.7lbft

Step 7 — J37 Acura

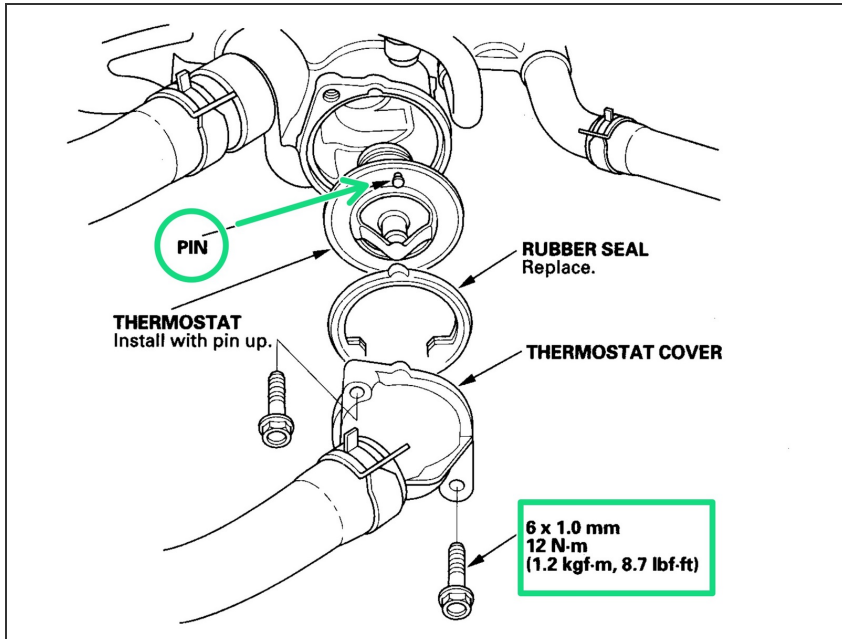

- Install with the pin up. Do not install upside down.
- Torque bolts to 8.7lbft.

Step 8 — H22 Prelude

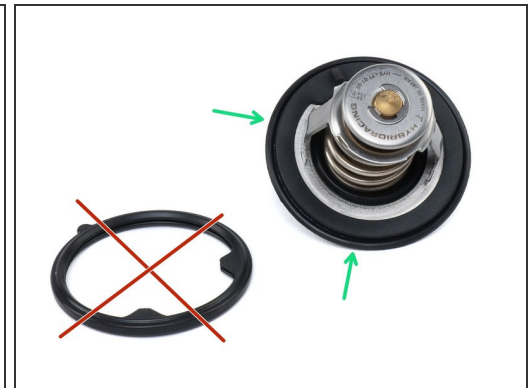
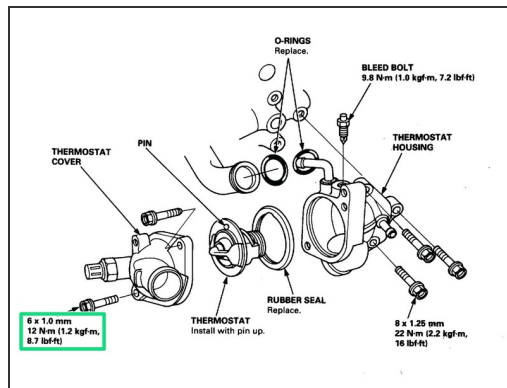
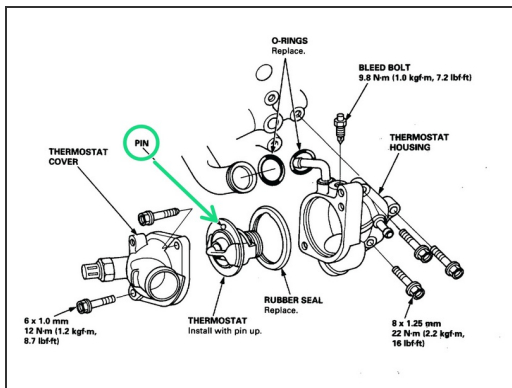

- Install with the pin up. Do not install upside down.

⚠ You MUST use the other gasket that is supplied in the package. This gasket is thicker and goes on one specific way. View step 2.

- Torque bolts to 8.7lbft.